

## Cylinder Head Shoulder Bolts

Steel / Stainless Steel

### SPECIFICATION

- Steel **ST**
- Property class 5.8
- Blackened
- Case-hardened (all round depth 0.2 to 0.4 mm)

Stainless steel **AISI 303 NI**

### INFORMATION

The dimensions  $d_2$  /  $l_1$  of the cylinder head shoulder bolts GN 732.1 permit a use as bearing pin for swing bolts DIN 444 (see page 935), swing bolts GN 1524 (see page 934) swing nuts GN 444.2 (see page 936) and hubs with eccentric cam GN 919 (see page 1055).

### TECHNICAL INFORMATION

- Strength values of screws / nuts (see page A20)
- Stainless Steel Characteristics (see page A26)

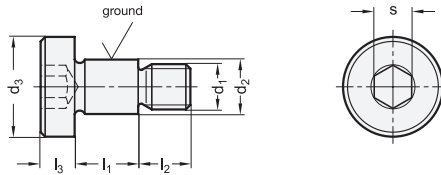

Application example

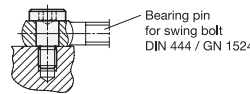

### GN 732.1

Description	d <sub>1</sub>	d <sub>2</sub>	h +0.20/+0.13	d <sub>3</sub>	l <sub>2</sub>	l <sub>3</sub>	s	⚖
GN 732.1-M5-6-5-ST	M 5	6 -0.03 / -0.05	5	12	7	3	3	4
GN 732.1-M5-6-6-ST	M 5	6 -0.03 / -0.05	6	12	7	3	3	4
GN 732.1-M5-6-7-ST	M 5	6 -0.03 / -0.05	7	12	7	3	3	5
GN 732.1-M5-6-8-ST	M 5	6 -0.03 / -0.05	8	12	7	3	3	5
GN 732.1-M6-8-5-ST	M 6	8 -0.05 / -0.08	5	14	8	4	4	8
GN 732.1-M6-8-6-ST	M 6	8 -0.05 / -0.08	6	14	8	4	4	9
GN 732.1-M6-8-8-ST	M 6	8 -0.05 / -0.08	8	14	8	4	4	8
GN 732.1-M6-8-9-ST	M 6	8 -0.05 / -0.08	9	14	8	4	4	9
GN 732.1-M6-8-10-ST	M 6	8 -0.05 / -0.08	10	14	8	4	4	8
GN 732.1-M6-8-12-ST	M 6	8 -0.05 / -0.08	12	14	8	4	4	10
GN 732.1-M6-8-13-ST	M 6	8 -0.05 / -0.08	13	14	8	4	4	8
GN 732.1-M8-10-8-ST	M 8	10 -0.05 / -0.08	8	16	11	5	5	14
GN 732.1-M8-10-10-ST	M 8	10 -0.05 / -0.08	10	16	11	5	5	15
GN 732.1-M8-10-12-ST	M 8	10 -0.05 / -0.08	12	16	11	5	5	17
GN 732.1-M8-10-14-ST	M 8	10 -0.05 / -0.08	14	16	11	5	5	19
GN 732.1-M8-10-15-ST	M 8	10 -0.05 / -0.08	15	16	11	5	5	18
GN 732.1-M10-12-12-ST	M 10	12 -0.05 / -0.08	12	19	13	6	6	28
GN 732.1-M10-12-14-ST	M 10	12 -0.05 / -0.08	14	19	13	6	6	30
GN 732.1-M10-12-16-ST	M 10	12 -0.05 / -0.08	16	19	13	6	6	26
GN 732.1-M10-12-17-ST	M 10	12 -0.05 / -0.08	17	19	13	6	6	33
GN 732.1-M12-14-14-ST	M 12	14 -0.05 / -0.08	14	22	16	8	8	48
GN 732.1-M12-14-16-ST	M 12	14 -0.05 / -0.08	16	22	16	8	8	50
GN 732.1-M12-14-18-ST	M 12	14 -0.05 / -0.08	18	22	16	8	8	53
GN 732.1-M14-16-17-ST	M 14	16 -0.05 / -0.08	17	25	19	8	8	71
GN 732.1-M14-16-18-ST	M 14	16 -0.05 / -0.08	18	25	19	8	8	73

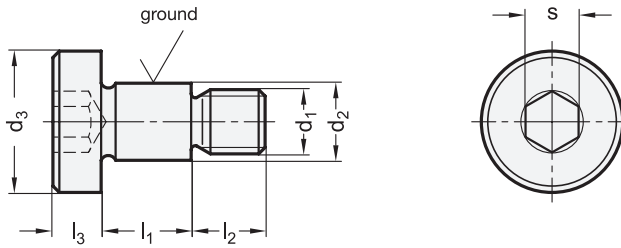

Application example

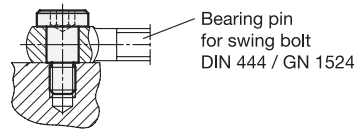

GN 732.1-NI

STAINLESS STEEL

Description	d1	d2	l1 +0.20/+0.13	d3	l2	l3	s	⚖
GN 732.1-M5-6-5-NI	M 5	6 -0.03 /-0.05	5	12	7	3	3	4
GN 732.1-M5-6-6-NI	M 5	6 -0.03 /-0.05	6	12	7	3	3	4
GN 732.1-M5-6-7-NI	M 5	6 -0.03 /-0.05	7	12	7	3	3	5
GN 732.1-M5-6-8-NI	M 5	6 -0.03 /-0.05	8	12	7	3	3	5
GN 732.1-M6-8-5-NI	M 6	8 -0.05/-0.08	5	14	8	4	4	7
GN 732.1-M6-8-6-NI	M 6	8 -0.05/-0.08	6	14	8	4	4	9
GN 732.1-M6-8-8-NI	M 6	8 -0.05/-0.08	8	14	8	4	4	9
GN 732.1-M6-8-9-NI	M 6	8 -0.05/-0.08	9	14	8	4	4	9
GN 732.1-M6-8-10-NI	M 6	8 -0.05/-0.08	10	14	8	4	4	9
GN 732.1-M6-8-12-NI	M 6	8 -0.05/-0.08	12	14	8	4	4	10
GN 732.1-M6-8-13-NI	M 6	8 -0.05/-0.08	13	14	8	4	4	12
GN 732.1-M8-10-8-NI	M 8	10 -0.05/-0.08	8	16	11	5	5	15
GN 732.1-M8-10-10-NI	M 8	10 -0.05/-0.08	10	16	11	5	5	16
GN 732.1-M8-10-12-NI	M 8	10 -0.05/-0.08	12	16	11	5	5	18
GN 732.1-M8-10-14-NI	M 8	10 -0.05/-0.08	14	16	11	5	5	19
GN 732.1-M8-10-15-NI	M 8	10 -0.05/-0.08	15	16	11	5	5	19
GN 732.1-M10-12-12-NI	M 10	12 -0.05/-0.08	12	19	13	6	6	28
GN 732.1-M10-12-14-NI	M 10	12 -0.05/-0.08	14	19	13	6	6	30
GN 732.1-M10-12-16-NI	M 10	12 -0.05/-0.08	16	19	13	6	6	31
GN 732.1-M10-12-17-NI	M 10	12 -0.05/-0.08	17	19	13	6	6	32
GN 732.1-M12-14-14-NI	M 12	14 -0.05/-0.08	14	22	16	8	8	50
GN 732.1-M12-14-16-NI	M 12	14 -0.05/-0.08	16	22	16	8	8	51
GN 732.1-M12-14-18-NI	M 12	14 -0.05/-0.08	18	22	16	8	8	53
GN 732.1-M14-16-17-NI	M 14	16 -0.05/-0.08	17	25	19	8	8	71
GN 732.1-M14-16-18-NI	M 14	16 -0.05/-0.08	18	25	19	8	8	73



Machine elements